

Eagle® O-Rings

- O-Rings for line shaft, live roller and motion transfer conveyors.
- High coefficient of friction.
- Elastic with excellent memory.
- Popular 1/8", 3/16", 1/4", 5mm and 6mm sizes in stock.
- Contact Fenner Drives for part numbers.



Twisted O-Rings

- Twisted O-Rings are an ideal fast fit solution for live roller conveyors.
- Twisted loop construction packaged with metal hooks. Plastic hooks also available.
- No need to dismantle drive components.

TWISTED O-RINGS		
Material and Color	Part Number	Dimensions
Eagle Clear 85	5050003	3/16" x 6"
	5050011	3/16" x 10"
	5050015	3/16" x 10-1/2"
	5050012	3/16" x 11"
	5050911	3/16" x 11-1/2"
	5050016	3/16" x 12"
	5050005	3/16" x 12-1/2"
	5050002	3/16" x 12-3/4"
	5050006	3/16" x 12-7/8"
	5050007	3/16" x 13"
	5050017	3/16" x 13-1/4"
	5050009	3/16" x 13-1/2"
	5050014	3/16" x 13-3/4"
	5050008	3/16" x 14"
	5050010	3/16" x 14-1/2"



Eagle Twisted O-Rings easily installed without dismantling line shaft.
50 pieces per box, packaged with metal hooks. Plastic hooks also available.

Eagle Fabricated Belts

Let us do the work for you and take the hassle out of fabricating your own endless belts.

- Available in all Eagle Belting colors and durometers (except Can Cable).
- Rapid order turnaround.

2mm, 3/32", 3mm, 1/8" Round Cross Sections Round Belting

NON-REINFORCED	Material and Color	Part Number	Dimensions Ø		Minimum Pulley Ø		Working Load @ Percent Tension								Weight	
			(in)	(mm)	(in)	(mm)	4%		6%		8%		10%		lbs/ft	kg/m
Eagle Blue 80 EC	4928000		2	0.55	14	0.1	0.7	0.2	1	0.3	1.4	0.4	1.7	0.002	0.004	
Eagle Clear 80 EC	4927000		2	0.55	14	0.1	0.7	0.2	1	0.3	1.4	0.4	1.7	0.002	0.004	
Eagle Opaque 80	L04OP802M		2	0.55	14	0.2	0.9	0.4	1.6	0.5	2.2	0.6	2.7	0.003	0.004	
Eagle Orange 85	L04OG852M		2	0.63	16	0.2	0.9	0.3	1.3	0.4	1.8	0.5	2.2	0.003	0.004	
Eagle Clear 85	L04C852M		2	0.63	16	0.2	0.9	0.3	1.3	0.4	1.8	0.5	2.2	0.003	0.004	
Eagle Green 89	4905402		2	0.71	18	0.3	1.4	0.5	2.4	0.7	3.2	0.9	4	0.003	0.004	
Eagle Green 89 Textured	4905302		2	0.71	18	0.2	1	0.4	1.7	0.5	2.3	0.7	2.9	0.003	0.004	
Eagle Red 90	4940017		2	0.79	20	1.1	4.7	1.5	6.8	1.9	8.5	2.2	10	0.003	0.004	
Eagle Orange 85	1032003		3/32		0.75	19	0.3	1.2	0.4	1.9	0.6	2.5	0.7	3.1	0.004	0.005
Eagle Clear 85	4908003		3/32		0.75	19	0.3	1.2	0.4	1.9	0.6	2.5	0.7	3.1	0.004	0.005
Eagle Clear 95	4907003		3/32		0.94	24	0.5	2.3	0.8	3.4	1	4.3	1.2	5.1	0.004	0.005
Eagle Orange 85	1032004		1/8		1	25	0.5	2.2	0.7	3.3	1	4.4	1.2	5.5	0.006	0.01
Eagle Clear 85	4908006		1/8		1	25	0.5	2.2	0.7	3.3	1	4.4	1.2	5.5	0.006	0.01
Eagle Clear 95	4907006		1/8		1.25	32	0.9	4	1.3	6	1.7	7.7	2.1	9.1	0.007	0.01
Eagle Blue 80 EC	4928001		3	0.83	21	0.4	1.7	0.6	2.5	0.8	3.5	1	4.3	0.005	0.008	
Eagle Clear 80 EC	4927001		3	0.83	21	0.4	1.7	0.6	2.5	0.8	3.5	1	4.3	0.005	0.008	
Eagle Opaque 80	L04OP803M		3	0.83	21	0.5	2.1	0.8	3.5	1.1	4.9	1.4	6.2	0.006	0.009	
Eagle Orange 85	L04OG853M		3	0.94	24	0.4	1.9	0.7	3	0.9	4	1.1	4.9	0.006	0.009	
Eagle Clear 85	L04C853M		3	0.94	24	0.4	1.9	0.7	3	0.9	4	1.1	4.9	0.006	0.009	
Eagle Blue 85	L04BL853M		3	0.94	24	0.4	1.9	0.7	3	0.9	4	1.1	4.9	0.006	0.009	
Eagle Green 89	L04G893MS		3	1.06	27	0.7	3.2	1.2	5.2	1.6	7.2	2	9	0.006	0.009	
Eagle Green 89 Textured	4905303		3	1.06	27	0.5	2.3	0.9	3.8	1.2	5.2	1.5	6.5	0.006	0.009	
Eagle Red 90	4940020		3	1.18	30	2.4	10.5	3.4	15.1	4.3	19	5	22.2	0.006	0.009	
Eagle White 40D	L04BY403M		3	1.42	36	1.9	8.3	2.9	12.8	3.8	16.8	4.5	20.2	0.006	0.008	

Dimensions are for reference only.

4mm, 5mm, 3/16" Round Cross Sections Round Belting

NON-REINFORCED	Part Number	Dimensions Ø (in) (mm)	Minimum Pulley Ø (in) (mm)	Working Load @ Percent Tension								Weight	
				4% (lbs) (N)		6% (lbs) (N)		8% (lbs) (N)		10% (lbs) (N)		lbs/ft	kg/m
Eagle® Blue 80 EC	4928002	4	1.1 28	0.6	2.8	0.9	4.2	1.3	5.6	1.5	6.7	0.009	0.014
Eagle Clear 80 EC	4927002	4	1.1 28	0.6	2.8	0.9	4.2	1.3	5.6	1.5	6.7	0.009	0.014
Eagle Opaque 80	L04OP804	4	1.1 28	0.8	3.7	1.4	6.2	2	8.7	2.5	11	0.01	0.015
Eagle Orange 85	L04OG854	4	1.26 32	0.8	3.4	1.2	5.3	1.6	7	1.9	8.6	0.01	0.015
Eagle Clear 85	L04C854	4	1.26 32	0.8	3.4	1.2	5.3	1.6	7	1.9	8.6	0.01	0.015
Eagle Red 85	L04R8504	4	1.26 32	0.8	3.4	1.2	5.3	1.6	7	2	8.7	0.01	0.015
Eagle Blue 85	L04BL854	4	1.26 32	0.8	3.4	1.2	5.3	1.6	7	2	8.7	0.01	0.015
Eagle Green 89	4905404	4	1.42 36	1.3	5.7	2.1	9.3	2.9	12.8	3.6	16	0.01	0.015
Eagle Green 89 Textured	4905304	4	1.42 36	0.9	4.1	1.5	6.8	2.1	9.3	2.6	11.6	0.01	0.015
Eagle Red 90	4940021	4	1.57 40	4.2	18.6	6	26.8	7.6	33.8	8.9	39.5	0.01	0.015
Eagle White 40D	L04BY404	4	1.89 48	3.3	14.8	5.1	22.8	6.7	29.8	8.1	36	0.01	0.015
Eagle Blue 80 MD	4941100	3/16	1.31 33	0.8	3.5	1.2	5.4	1.6	7	1.9	8.6	0.013	0.02
Eagle Orange 85	1032006	3/16	1.5 38	1.1	4.9	1.7	7.5	2.2	10	2.8	12.3	0.014	0.021
Eagle Clear 85	4908009	3/16	1.5 38	1.1	4.9	1.7	7.5	2.2	10	2.8	12.3	0.014	0.021
Eagle Red 90	4940022	3/16	1.88 48	6	26.5	8.6	38.2	10.8	48.1	12.6	56.2	0.014	0.022
Eagle Clear 95	4907009	3/16	1.88 48	2	9.1	3	13.5	3.9	17.3	4.6	20.6	0.015	0.022
Eagle Clear 85 QC	4934009	.188 x .080*	1.5 38	0.5	2	0.7	3.1	0.9	4.2	1.2	5.2	0.012	0.018
Eagle Yellow 85 QC	4934021	.188 x .080*	1.5 38	0.5	2	0.7	3.1	0.9	4.2	1.2	5.2	0.012	0.018
Eagle Blue 80 EC	4928003	5	1.38 35	0.9	4.2	1.4	6.3	1.9	8.4	2.4	10.6	0.015	0.022
Eagle Clear 80 EC	4927003	5	1.38 35	0.9	4.2	1.4	6.3	1.9	8.4	2.4	10.6	0.015	0.022
Eagle Opaque 80	L04OP805M	5	1.38 35	1.3	5.7	2.2	9.7	3.1	13.6	3.9	17.2	0.016	0.024
Eagle Orange 85	4940100	5	1.57 40	1.2	5.4	1.9	8.3	2.5	11	3.1	13.6	0.016	0.024
Eagle Clear 85	L04C855M	5	1.57 40	1.2	5.3	1.9	8.2	2.5	11	3	13.5	0.016	0.024
Eagle Red 85	L04R855	5	1.57 40	1.2	5.3	1.9	8.2	2.5	11	3	13.5	0.016	0.024
Eagle Blue 85	L04BL855M	5	1.57 40	1.2	5.3	1.9	8.2	2.5	11	3	13.5	0.016	0.024
Eagle Green 89	4905405	5	1.77 45	2	8.9	3.3	14.6	4.5	20.1	5.6	25.1	0.016	0.023
Eagle Green 89 Textured	4905305	5	1.77 45	1.5	6.5	2.4	10.6	3.3	14.6	4.1	18.2	0.016	0.023
Eagle Red 90	L04R9005M	5	1.97 50	6	26.5	8.6	38.2	10.8	48.1	12.6	56.2	0.014	0.022
Eagle Beige 95	L04BE955M	5	1.97 50	5.3	23.6	7.5	33.4	9.4	41.8	11	48.8	0.016	0.024
Eagle White 40D	L04BY405M	5	2.36 60	5.2	23.1	8	35.5	10.5	46.6	12.6	56.2	0.015	0.023
Eagle Blue 80 EC QC	4928020	5 x 2*	1.38 35	0.4	1.8	0.6	2.8	0.8	3.7	1	4.6	0.012	0.018
Eagle Clear 85 QC	L04QC855M	5 x 2*	1.57 40	0.5	2.3	0.8	3.5	1.1	4.7	1.3	5.8	0.013	0.02
Eagle Red 85 QC	L04QR855M	5 x 2*	1.57 40	0.5	2.3	0.8	3.5	1.1	4.7	1.3	5.8	0.013	0.02
Eagle Blue 85 QC	L04QB855M	5 x 2*	1.38 35	0.5	2.3	0.8	3.5	1.1	4.7	1.3	5.8	0.013	0.02
QC Connectors	4935009	25/pack											

REINFORCED	Part Number	Dimensions Ø (in) (mm)	Minimum Pulley Ø (in) (mm)	Working Load @ Percent Tension								Weight	
Material and Color				1% (lbs) (N)		2% (lbs) (N)		3% (lbs) (N)		4% (lbs) (N)		lbs/ft	kg/m
Eagle Hyfen 85	5218009	3/16	2.06 52	2.8	12.5	6.8	30.2	11.2	49.8	15.5	68.9	0.014	0.021
Eagle Green 89	L04G895MRS	5	1.97 50	1.7	7.4	5	22.2	10.2	45.4	15.7	70.1	0.016	0.023
Eagle Green 89 Textured	4940056	5	1.97 50	2.3	10.2	6.9	30.5	14	62.5	21.7	96.3	0.016	0.023

Trackstar® Round Belt Guides

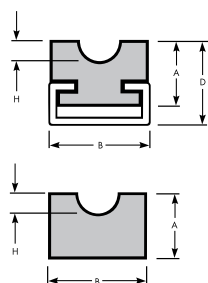

Part Numbers	Channel Type	A	B	D	H
Belt Guide w/ Mounting Channel	C3	0.59	0.79	0.8	0.13

Part Number	A	B	H	
Belt Guide	NC1006	0.38	0.75	0.13

* QC dimensions are shown O.D x I.D. (O.D. is the outer diameter of the belt. I.D. is the inner diameter of the belt.) Dimensions are for reference only.

6mm, 1/4" Round Cross Sections

Round Belting

NON-REINFORCED				Working Load @ Percent Tension										Weight	
Material and Color	Part Number	Dimensions Ø (in) (mm)	Minimum Pulley Ø (in) (mm)	4% (lbs) (N)		6% (lbs) (N)		8% (lbs) (N)		10% (lbs) (N)		lbs/ft	kg/m		
Eagle® Blue 80 EC	4928004	6	1.65 42	1.3	5.9	2.1	9.1	2.8	12.3	3.4	15.2	0.021	0.032		
Eagle Clear 80 EC	4927004	6	1.65 42	1.3	5.9	2.1	9.1	2.8	12.3	3.4	15.2	0.021	0.032		
Eagle Opaque 80	L04OP806M	6	1.65 42	1.9	8.2	3.2	14	4.4	19.6	5.6	24.7	0.023	0.034		
Eagle Orange 85	L04OG856M	6	1.89 48	1.7	7.7	2.7	11.8	3.5	15.8	4.4	19.4	0.023	0.034		
Eagle Clear 85	L04C856M	6	1.89 48	1.7	7.7	2.7	11.8	3.5	15.8	4.4	19.4	0.023	0.034		
Eagle Blue 85	L04BL856M	6	1.89 48	1.7	7.7	2.7	11.9	3.6	15.8	4.4	19.5	0.023	0.034		
Eagle Green 89	4905406	6	2.13 54	2.9	12.8	4.7	21	6.5	28.9	8.1	36.1	0.023	0.034		
Eagle Green 89 Textured	4905306	6	2.13 54	2.1	9.3	3.4	15.3	4.7	21	5.9	26.2	0.023	0.034		
Eagle White 40D	L04BY406M	6	2.83 72	7.5	33.3	11.5	51.2	15.1	67.1	18.2	80.9	0.022	0.033		
Eagle Blue 80 EC QC	4928021	6 x 2.5*	1.65 42	0.6	2.5	0.9	3.9	1.2	5.3	1.5	6.6	0.018	0.026		
Eagle Clear 85 QC	L04QC856M	6 x 2.5*	1.89 48	0.7	3.2	1.1	5	1.5	6.7	1.9	8.3	0.019	0.028		
Eagle Red 85 QC	L04QR856M	6 x 2.5*	1.89 48	0.7	3.2	1.1	5	1.5	6.7	1.9	8.3	0.019	0.028		
Eagle Blue 85 QC	L04QB856M	6 x 2.5*	1.89 48	0.7	3.2	1.1	5	1.5	6.7	1.9	8.3	0.019	0.028		
Eagle Blue 80 MD	4941101	1/4 6.3	1.75 44	1.3	6	2.1	9.2	2.8	12.3	3.4	15.3	0.024	0.035		
Eagle Opaque 80	4940003	1/4 6.3	1.75 44	2.1	9.2	3.5	15.7	4.9	22	6.2	27.7	0.026	0.039		
Eagle Orange 85	1032008	1/4 6.3	2 51	1.9	8.6	3	13.3	4	17.7	4.9	21.9	0.026	0.038		
Eagle Clear 85	4908012	1/4 6.3	2 51	1.9	8.6	3	13.3	4	17.7	4.9	21.9	0.026	0.038		
Eagle Red 90	4940023	1/4 6.3	2.5 64	10.6	47.2	15.3	67.9	19.2	85.5	22.5	100	0.026	0.038		
Eagle Clear 95	4907012	1/4 6.3	2.5 64	3.6	16.1	5.4	24	6.9	30.8	8.2	36.6	0.026	0.039		
Eagle Clear 85 QC	4934012	.250 x .098*	2 51	0.8	3.7	1.3	5.7	1.7	7.7	2.1	9.5	0.022	0.032		
Eagle Yellow 85 QC	4934022	.250 x .098*	2 51	0.8	3.7	1.3	5.7	1.7	7.7	2.1	9.5	0.022	0.032		
Eagle Blue 80 EC	4928005	1/4 6.3	1.74 44	1.5	6.6	2.3	10.2	3.1	13.7	3.8	17	0.023	0.035		
Eagle Blue 85	L04BL856.3	1/4 6.3	2 51	1.9	8.6	3	13.3	4	17.7	4.9	21.8	0.025	0.037		
QC Connectors	L04CON6S	25/pack													

REINFORCED				Working Load @ Percent Tension										Weight	
Material and Color	Part Number	Dimensions Ø (in) (mm)	Minimum Pulley Ø (in) (mm)	1% (lbs) (N)		2% (lbs) (N)		3% (lbs) (N)		4% (lbs) (N)		lbs/ft	kg/m		
Eagle Orange 85	L04OG856MR	6	2.36 60	0.7	3.2	2.5	11	4.8	21.5	6.9	30.8	0.023	0.034		
Eagle Green 89	L04G896MSR	6	2.36 60	2.4	10.6	7.2	32	14.7	65.5	22.7	100.9	0.023	0.034		
Eagle Green 89 Textured	4940057	6	2.36 60	3.3	14.6	9.9	43.9	20.2	90	31.2	138.8	0.023	0.034		
Eagle Orange 85	4940058	1/4 6.3	2.5 64	0.8	3.6	2.8	12.3	5.4	24.1	7.8	34.6	0.026	0.038		
Eagle Hyfen 85	5218012	1/4 6.3	2.75 70	3.7	16.5	12.4	55.2	20	89	27.8	123.7	0.026	0.038		

Trackstar® Round Belt Guides

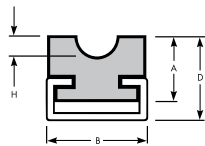

	Part Numbers			Channel Type	A	B	D	H
	Galvanized Channel	Stainless Steel Channel	Aluminum Channel					
Belt Guide w/ Mounting Channel	GB1000-3G	GB1000-3S	GB1000-3A	C3	0.59	0.79	0.8	0.16

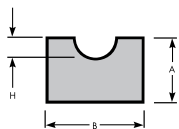

	Part Number	A	B	H
Belt Guide	NC1000	0.38	0.75	0.16

* QC dimensions are shown O.D x I.D. (O.D. is the outer diameter of the belt. I.D. is the inner diameter of the belt.) Dimensions are for reference only.

7mm, 8mm, 5/16" Round Cross Sections

Round Belting

NON-REINFORCED		Part Number	Dimensions Ø		Minimum Pulley Ø		Working Load @ Percent Tension								Weight	
Material and Color	(in)		(mm)	(in)	(mm)	4% (lbs)	4% (N)	6% (lbs)	6% (N)	8% (lbs)	8% (N)	10% (lbs)	10% (N)	lbs/ft	kg/m	
Eagle® Orange 85	L04OG857M		7	2.2	56	2.4	10.5	3.6	16.2	4.8	21.6	6	26.6	0.031	0.046	
Eagle Clear 85	L04C857M		7	2.2	56	2.4	10.5	3.6	16.2	4.8	21.6	6	26.6	0.031	0.046	
Eagle Green 89	4999637		7	2.48	63	3.9	17.4	6.4	28.6	8.8	39.3	11	49.1	0.031	0.046	
Eagle Green 89 Textured	4905307		7	2.48	63	2.9	12.7	4.7	20.9	6.4	28.7	8.1	35.8	0.031	0.046	
Eagle Red 90	L04R907		7	2.76	70	12.9	57.4	18.6	82.7	23.4	104.1	27.4	121.8	0.031	0.047	
Eagle Blue 80 MD	4941102	5/16		2.19	56	2.1	9.4	3.3	14.5	4.3	19.3	5.5	24.3	0.037	0.055	
Eagle Orange 85	1032010	5/16		2.5	64	3	13.5	4.7	20.8	6.2	27.7	7.7	34.1	0.04	0.059	
Eagle Clear 85	4908015	5/16		2.5	64	3	13.5	4.7	20.8	6.2	27.7	7.7	34.1	0.04	0.059	
Eagle Clear 95	4907015	5/16		3.13	79	5.7	25.2	8.4	37.4	10.8	48.1	12.9	57.2	0.041	0.061	
Eagle Clear 85 QC	4934015	.313 x .126*		2.5	64	1.3	5.7	2	8.9	2.7	11.9	3.3	14.7	0.034	0.05	
Eagle Yellow 85 QC	4934023	.313 x .126*		2.5	64	1.3	5.7	2	8.9	2.7	11.9	3.3	14.7	0.034	0.05	
Eagle Blue 80 EC	4928006		8	2.2	56	2.4	10.5	3.6	16.2	4.8	21.5	6.1	26.9	0.038	0.056	
Eagle Clear 80 EC	4927006		8	2.2	56	2.4	10.5	3.6	16.2	4.8	21.5	6.1	26.9	0.038	0.056	
Eagle Opaque 80	L04OP808M		8	2.2	56	3.3	14.7	5.6	25	7.8	34.9	9.9	43.9	0.041	0.061	
Eagle Orange 85	L04OG858M		8	2.52	64	3.1	13.7	4.7	21.1	6.3	28.1	7.8	34.7	0.041	0.06	
Eagle Clear 85	L04C858		8	2.52	64	3.1	13.7	4.7	21.1	6.3	28.1	7.8	34.7	0.041	0.06	
Eagle Blue 85	L04BL858M		8	2.52	64	3.1	13.7	4.7	21.1	6.3	28.1	7.8	34.7	0.041	0.06	
Eagle Green 89	L04G898MS		8	2.83	72	5.1	22.8	8.4	37.4	11.5	51.3	14.4	64.1	0.04	0.06	
Eagle Green 89 Textured	4905308		8	2.83	72	3.7	16.6	6.1	27.2	8.4	37.3	10.5	46.7	0.04	0.06	
Eagle Red 90	4940024		8	3.15	80	16.8	74.9	24.3	107.9	30.5	135.8	35.7	158.9	0.041	0.061	
Eagle Beige 95	L04BE958		8	3.15	80	13.6	60.5	19.3	85.7	24.1	107	28.1	125.1	0.042	0.062	
Eagle White 40D	L04BY408M		8	3.78	96	13.3	59.2	20.5	91	26.8	119.3	32.3	143.8	0.04	0.059	
Eagle Blue 80 EC QC	4928022		8 x 3.2*	2.2	56	1	4.6	1.6	7.1	2.2	9.6	2.7	11.9	0.032	0.047	
Eagle Clear 85 QC	L04QC858M		8 x 3.2*	2.52	64	1.3	5.8	2	9	2.7	12.1	3.4	14.9	0.034	0.051	
Eagle Red 85 QC	L04QR858M		8 x 3.2*	2.52	64	1.3	5.8	2	9	2.7	12.1	3.4	14.9	0.034	0.051	
Eagle Blue 85 QC	L04QB858M		8 x 3.2*	2.52	64	1.3	5.7	2	8.9	2.7	11.9	3.3	14.6	0.034	0.051	
QC Connectors	L04CON85	25/pack														
REINFORCED		Part Number	Dimensions Ø		Minimum Pulley Ø		Working Load @ Percent Tension								Weight	
Material and Color	(in)		(mm)	(in)	(mm)	1% (lbs)	1% (N)	2% (lbs)	2% (N)	3% (lbs)	3% (N)	4% (lbs)	4% (N)	lbs/ft	kg/m	
Eagle Green 89	L04G897MRS		7	2.76	70	3.3	14.5	9.8	43.5	20.1	89.2	30.9	137.6	0.031	0.046	
Eagle Green 89 Textured	4940050		7	2.76	70	4.5	19.9	13.5	59.9	27.6	122.7	42.5	189.2	0.031	0.046	
Eagle Orange 85	4940059	5/16		3.13	79	1.3	5.6	4.3	19.3	8.5	37.6	12.1	54	0.04	0.059	
Eagle Hyfen 85	5218015	5/16		3.44	87	3.7	16.5	12.4	55.2	20	89	27.8	123.7	0.04	0.059	
Eagle Orange 85	L04OG858R		8	3.15	80	1.3	5.7	4.4	19.6	8.6	38.2	12.3	54.8	0.041	0.06	
Eagle Green 89	L04G898MRS		8	3.15	80	4.3	18.9	12.8	56.8	26.2	116.4	40.4	179.5	0.04	0.06	
Eagle Green 89 Textured	4940051		8	3.15	80	5.8	26	17.6	78.2	36	160.1	55.5	246.8	0.04	0.06	
Eagle Beige 95	L04BE958R		8	3.78	96	3.8	16.9	7	31.1	10.4	46.3	13.6	60.5	0.042	0.062	

Trackstar® Round Belt Guides

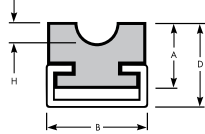

	Part Numbers			Channel Type	A	B	D	H
	Galvanized Channel	Stainless Steel Channel	Aluminum Channel					
Belt Guide w/ Mounting Channel	GB1001-3G	GB1001-3S	GB1001-3A	C3	0.59	0.79	0.8	0.19

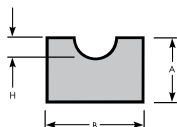

	Part Number	A	B	H
Belt Guide	NC1001	0.5	0.75	0.19

* QC dimensions are shown O.D x I.D. (O.D. is the outer diameter of the belt. I.D. is the inner diameter of the belt.) Dimensions are for reference only.

9mm, 9.5mm, 3/8" Round Cross Sections

Round Link Belting

LINK BELTING	Part Number		Cross Section	Minimum Pulley Ø		Max Product Weight w/Idlers		Max Product Weight w/UHMW	
	25'	10m		(in)	(mm)	(lbs)	(kg)	(lbs)	(kg)
Tango™ Belting	0470225	0470233	3/8"	3.0	76	190	86	65	30

Round Belting

NON-REINFORCED				Working Load @ Percent Tension										Weight	
Material and Color	Part Number	Dimensions Ø		Minimum Pulley Ø		4%		6%		8%		10%		lbs/ft	kg/m
		(in)	(mm)	(in)	(mm)	(lbs)	(N)	(lbs)	(N)	(lbs)	(N)	(lbs)	(N)		
Eagle® Green 89 Textured	L04G899		9	3.19	81	4.7	21	7.7	34.4	10.6	47.2	13.3	59	0.051	0.076
Eagle Blue 80 MD	4941103	3/8	9.5	2.63	67	3	13.5	4.7	20.9	6.3	27.9	7.8	34.8	0.054	0.08
Eagle Opaque 80	4940005	3/8	9.5	2.63	67	4.7	20.8	8	35.4	11.1	49.4	14	62.3	0.058	0.087
Eagle Orange 85	1032012	3/8	9.5	3	76	4.4	19.4	6.7	29.9	9	39.9	11.1	49.2	0.057	0.086
Eagle Clear 85	4908018	3/8	9.5	3	76	4.4	19.4	6.7	29.9	9	39.9	11.1	49.2	0.057	0.086
Eagle Red 90	4940025	3/8	9.5	3.75	95	23.9	106.1	34.4	152.9	43.3	192.4	50.6	225.1	0.058	0.086
Eagle Clear 95	4907018	3/8	9.5	3.75	95	8.2	36.3	12.1	53.9	15.6	69.3	18.5	82.4	0.059	0.088
Eagle Clear 85 QC	4934018	.375 x .152*		3	76	1.8	8.2	2.9	12.7	3.8	17.1	4.7	21	0.048	0.071
Eagle Yellow 85 QC	4934025	.375 x .152*		3	76	1.8	8.2	2.9	12.7	3.8	17.1	4.7	21	0.048	0.071
Eagle Blue 80 EC	4928007	3/8	9.5	2.62	67	3.4	15	5.2	23.2	7	31	8.7	38.7	0.053	0.079
Eagle Blue 85	L04BL859.5M	3/8	9.5	3	76	4.4	19.4	6.7	29.9	9	39.9	11.1	49.2	0.057	0.085
Eagle Green 89	L04G899.5MS	3/8	9.5	3.39	86	7.2	32.1	11.8	52.7	16.3	72.4	20.3	90.4	0.057	0.084
Eagle Blue 80 EC QC	4928023	9.5 x 3.8*		2.64	67	1.5	6.4	2.3	10.1	3	13.5	3.8	16.8	0.045	0.067
QC Connectors	L04CON10S	20/pack													
REINFORCED				Working Load @ Percent Tension										Weight	
Material and Color	Part Number	Dimensions Ø		Minimum Pulley Ø		1%		2%		3%		4%		lbs/ft	kg/m
		(in)	(mm)	(in)	(mm)	(lbs)	(N)	(lbs)	(N)	(lbs)	(N)	(lbs)	(N)		
Eagle Orange 85	4940060	3/8	9.5	3.75	95	1.8	8	6.2	27.8	12.2	54.2	17.5	77.8	0.057	0.086
Eagle Hyfen 85	5218018	3/8	9.5	4.13	105	7.3	32.5	26.2	116.5	43.5	193.5	57.4	255.3	0.057	0.086
Blue 55D Can Cable	4816019	3/8	9.5	12	305	18.1	80.4	42.9	190.6	79.4	353.1	118.4	526.5	0.057	0.086
Natural 55D Can Cable	4816018	3/8	9.5	12	305	18.1	80.4	42.9	190.6	79.4	353.1	118.4	526.5	0.057	0.086
Natural 63D Can Cable	4899006	3/8	9.5	12	305	18.1	80.4	42.9	190.6	79.4	353.1	118.4	526.5	0.058	0.087
Red 50D LCF Can Cable	4816020	3/8	9.5	10	254	23.8	105.9	57.8	257.2	104.3	463.8	152.3	677.2	0.058	0.087
Green 63D Can Cable	4817018	3/8	9.5	12	305	18.1	80.4	42.9	190.6	79.4	353.1	118.4	526.5	0.058	0.087
Blue 55D Aramid Can Cable	4899012	3/8	9.5	12	305	41.7	185.5	149.1	663.2	281.1	1250.4	—	—	0.057	0.086

Trackstar® Round Belt Guides

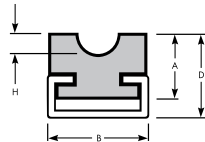

	Part Numbers			Channel Type	A	B	D	H
	Galvanized Channel	Stainless Steel Channel	Aluminum Channel					
Belt Guide w/ Mounting Channel	GB1002-5G	GB1002-5S		C5	0.59	1.1	0.84	0.22

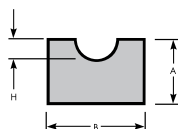

	Part Number	A	B	H
Belt Guide	NC1002	0.63	1	0.22

* QC dimensions are shown O.D x I.D. (O.D. is the outer diameter of the belt. I.D. is the inner diameter of the belt.) Dimensions are for reference only.

10mm, 12mm, 12.7mm, 1/2" Round Cross Sections

Round Link Belting

LINK BELTING	Part Number		Cross Section	Minimum Pulley Ø		Max Product Weight w/Idlers		Max Product Weight w/UHMW	
	25'	10m		(in)	(mm)	(lbs)	(kg)	(lbs)	(kg)
Tango™ Belting	0470325	0470333	1/2"	3.0	76	255	116	85	39

Round Belting

NON-REINFORCED	Part Number	Dimensions Ø		Minimum Pulley Ø	Working Load @ Percent Tension								Weight		
					4%		6%		8%		10%		lbs/ft	kg/m	
Material and Color		(in)	(mm)	(in)	(mm)	(lbs)	(N)	(lbs)	(N)	(lbs)	(N)	(lbs)	(N)		
Eagle® Blue 80 EC	4928008		10	2.76	70	3.7	16.4	5.8	25.6	7.7	34.1	9.6	42.6	0.059	0.088
Eagle Clear 80 EC	4927008		10	2.76	70	3.7	16.4	5.8	25.6	7.7	34.1	9.6	42.6	0.059	0.088
Eagle Opaque 80	L04OP8010M		10	2.76	70	5.1	22.9	8.8	39	12.2	54.5	15.4	68.6	0.064	0.096
Eagle Orange 85	L04OG8510M		10	3.15	80	4.8	21.4	7.4	33	9.9	44	12.2	54.2	0.063	0.094
Eagle Clear 85	L04C8510M		10	3.15	80	4.8	21.4	7.4	33	9.9	44	12.2	54.2	0.063	0.094
Eagle Blue 85	L04BL8510M		10	3.15	80	4.8	21.4	7.4	33	9.9	44	12.2	54.2	0.063	0.094
Eagle Green 89	L04G8910MS		10	3.54	90	8	35.4	13.1	58.2	18	79.9	22.4	99.8	0.063	0.093
Eagle Green 89 Textured	4905310		10	3.54	90	5.8	25.8	9.5	42.3	13.1	58.1	16.3	72.5	0.063	0.093
Eagle Red 90	L04R9010M		10	3.94	100	26.3	116.9	37.9	168.4	47.6	211.9	55.7	248	0.064	0.095
Eagle Beige 95	L04BE9510M		10	3.94	100	21.2	94.5	30.1	133.8	37.6	167.2	43.9	195.5	0.065	0.097
Eagle White 40D	L04BY4010M		10	4.72	120	20.8	92.5	32	142.2	41.9	186.5	50.5	224.6	0.062	0.092
Eagle Blue 55D	L04BY5510M		10	5.12	130	39.3	174.6	60.4	268.7	78.5	349.2	93	413.8	0.063	0.094
Eagle Red 85 QC	L04QR8510M		10 x 3.8*	3.15	80	2.1	9.3	3.2	14.4	4.3	19.3	5.3	23.8	0.054	0.081
Eagle Blue 85 QC	L04QB8510M		10 x 3.8*	3.15	80	2.1	9.3	3.2	14.4	4.3	19.3	5.3	23.8	0.054	0.081
Eagle Orange 85	L04OG8512M		12	3.78	96	6.9	30.8	10.7	47.5	14.2	63.3	17.5	78	0.091	0.136
Eagle Clear 85	L04C8512M		12	3.78	96	6.9	30.8	10.7	47.5	14.2	63.3	17.5	78	0.091	0.136
Eagle Green 89	L04G8912MS		12	4.25	108	11.5	51.2	18.9	84.1	26	115.5	32.4	144.3	0.09	0.135
Eagle Green 89 Textured	4905312		12	4.25	108	8.4	37.3	13.8	61.2	18.9	84.1	23.6	105.1	0.091	0.135
Eagle Red 90	L04R9012M		12	4.72	120	37.8	168.4	54.5	242.5	68.6	305.2	80.3	357.2	0.092	0.137
Eagle Red 85 QC	L04QCR8512M		12 x 5.2*	3.78	96	2.8	12.6	4.4	19.7	5.9	26.3	7.3	32.5	0.074	0.11
Eagle Blue 85 QC	L04QB8512		12 x 5.2*	3.78	96	2.8	12.6	4.4	19.7	5.9	26.3	7.3	32.5	0.074	0.11
Eagle Blue 80 MD	4941105	1/2	12.7	3.5	89	5.4	23.9	8.4	37.3	11.2	49.7	13.8	61.6	0.095	0.142
Eagle Orange 85	1032016	1/2	12.7	4	102	7.8	34.5	12	53.2	16	71	19.6	87.4	0.102	0.152
Eagle Clear 85	4908024	1/2	12.7	4	102	7.8	34.5	12	53.2	16	71	19.6	87.4	0.102	0.152
Eagle Red 90	4940026	1/2	12.7	5	127	42.4	188.6	61.1	271.7	76.9	342	90	400.2	0.103	0.153
Eagle Clear 95	4907024	1/2	12.7	5	127	14.5	64.6	21.6	95.9	27.7	123.1	32.9	146.4	0.105	0.156
Eagle Clear 85 QC	4934024	.500 x .205*		4	102	3.3	14.5	5.1	22.5	6.8	30.2	8.4	37.2	0.085	0.126
Eagle Yellow 85 QC	4934026	.500 x .205*		4	102	3.3	14.5	5.1	22.5	6.8	30.2	8.4	37.2	0.085	0.126
Eagle Red 85	L04R8512.7	1/2	12.7	4	102	7.8	34.5	12	53.2	16	71	19.6	87.4	0.102	0.152
Eagle Blue 85	L04BL8512.7	1/2	12.7	4	102	7.8	34.5	12	53.2	15.9	70.9	19.6	87.4	0.102	0.152
QC Connectors	L04CON10S	20/pack (Use for 3/8" and 10mm)													
QC Connectors	L04CON13S	20/pack (Use for 1/2" and 12-13mm)													
REINFORCED	Part Number	Dimensions Ø		Minimum Pulley Ø	Working Load @ Percent Tension								Weight		
Material and Color					(in)	(mm)	(in)	(mm)	1%		2%		3%		4%
						(lbs)	(N)	(lbs)	(N)	(lbs)	(N)	(lbs)	(N)		
Eagle Orange 85	L04OG8510MR		10	3.94	100	2	8.8	6.9	30.6	13.4	59.7	19.3	85.7	0.063	0.094
Eagle Green 89	L04G8910MRS		10	3.94	100	6.6	29.5	20	88.8	40.9	181.9	63.1	280.5	0.063	0.093
Eagle Green 89 Textured	4940052		10	3.94	100	9.1	40.6	27.5	122.1	56.2	250.1	86.7	385.6	0.063	0.093
Eagle Beige 95	L04BE9510R		10	4.72	120	6	26.7	11	48.9	16.2	72.1	21.2	94.3	0.065	0.097
Eagle Orange 85	L04OG8512R		12	4.72	120	2.9	12.7	9.9	44.1	19.3	85.9	27.7	123.4	0.091	0.136
Eagle Green 89	L04G8912MRS		12	4.72	120	9.6	42.6	28.8	127.9	58.9	262	90.8	404	0.09	0.135
Eagle Green 89 Textured	4940053		12	4.72	120	13.2	58.5	39.5	175.9	81	360.2	124.9	555.4	0.09	0.135
Eagle Orange 85	4940061	1/2	12.7	5	127	3.2	14.2	11.1	49.4	21.6	96.3	31.1	138.3	0.102	0.152
Eagle Hyfen 85	5218024	1/2	12.7	5.5	140	7.3	32.5	26.2	116.5	43.5	193.5	57.4	255.3	0.102	0.152

Trackstar® Round Belt Guides

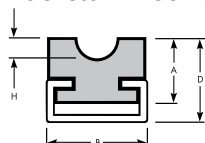

	Part Numbers			Channel Type	A	B	D	H
	Galvanized Channel	Stainless Steel Channel	Aluminum Channel					
Belt Guide w/ Mounting Channel	GB1003-5G	GB1003-5S		C5	0.59	1.1	0.84	0.28

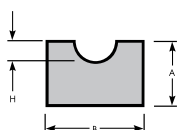

	Part Number	A	B	H
Belt Guide	NC1003	0.75	1.25	0.28

* QC dimensions are shown O.D x I.D. (O.D. is the outer diameter of the belt. I.D. is the inner diameter of the belt.) Dimensions are for reference only.

13mm, 9/16" Round Cross Sections

Round Link Belting

LINK BELTING	Part Number		Cross Section	Minimum Pulley Ø		Max Product Weight w/Idlers		Max Product Weight w/UHMW	
	25'	10m		(in)	(mm)	(lbs)	(kg)	(lbs)	(kg)
Tango™ Belting	0470425	0470433	9/16"	5.5	140	450	204	155	70

Round Belting

NON-REINFORCED				Working Load @ Percent Tension								Weight			
Material and Color	Part Number	Dimensions Ø		Minimum Pulley Ø		4%		6%		8%		10%		lbs/ft	kg/m
		(in)	(mm)	(in)	(mm)	(lbs)	(N)	(lbs)	(N)	(lbs)	(N)	(lbs)	(N)		
Eagle® Clear 85 QC	L04QC8513	13 x 5.2*		4.09	104	3.5	15.3	5.4	23.8	7.2	31.9	8.9	39.4	0.09	0.134
Eagle Red 85 QC	L04QCR8513M	13 x 5.2*		4.09	104	3.5	15.3	5.4	23.8	7.2	31.9	8.9	39.4	0.09	0.134
Eagle Blue 80 MD	4941106	9/16		3.94	100	6.9	30.6	10.6	47.1	14.2	63	17.6	78.2	0.121	0.18
Eagle Orange 85	1032018	9/16		4.5	114	9.8	43.7	15.1	67.3	20.2	89.8	24.9	110.6	0.129	0.192
Eagle Clear 85	4908027	9/16		4.5	114	9.8	43.7	15.1	67.3	20.2	89.8	24.9	110.6	0.129	0.192
Eagle Red 90	4940036	9/16		5.63	143	53.7	238.6	77.3	343.8	97.3	432.7	113.8	506.3	0.13	0.194
Eagle Clear 95	4907027	9/16		5.63	143	18.4	81.7	27.3	121.3	35	155.8	41.7	185.3	0.133	0.197
QC Connectors	L04CON13S	20/pack													
REINFORCED				Working Load @ Percent Tension								Weight			
Material and Color	Part Number	Dimensions Ø		Minimum Pulley Ø		1%		2%		3%		4%		lbs/ft	kg/m
		(in)	(mm)	(in)	(mm)	(lbs)	(N)	(lbs)	(N)	(lbs)	(N)	(lbs)	(N)		
Eagle Orange 85	4940062	9/16		5.63	143	4.1	18	14	62.5	27.4	121.8	39.3	174.9	0.129	0.192
Eagle Hyfen 85	5218027	9/16		6.19	157	16.7	74.3	36.6	162.8	58	258	75.8	337.2	0.129	0.192

Trackstar® Round Belt Guides

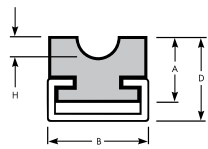

	Part Numbers			Channel Type	A	B	D	H
	Galvanized Channel	Stainless Steel Channel	Aluminum Channel					
Belt Guide w/ Mounting Channel	GB1004-5G	GB1004-5S		C5	0.59	1.1	0.84	0.32

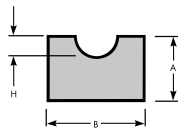

	Part Number	A	B	H
Belt Guide	NC1004	1	1.25	0.32

* QC dimensions are shown O.D x I.D. (O.D. is the outer diameter of the belt. I.D. is the inner diameter of the belt.) Dimensions are for reference only.

15mm, 16mm, 5/8" Round Cross Sections

Round Belting

NON-REINFORCED		Part Number	Dimensions Ø		Minimum Pulley Ø		Working Load @ Percent Tension								Weight	
Material and Color	(in)		(mm)	(in)	(mm)	4% (N)		6% (N)		8% (N)		10% (N)		lbs/ft	kg/m	
Eagle® Opaque 80	L04OP8015M		15	4.13	105	11.6	51.6	19.7	87.7	27.6	122.6	34.7	154.4	0.145	0.216	
Eagle Blue 85	L04BL8515		15	4.72	120	10.8	48.1	16.7	74.2	22.2	99	27.4	121.9	0.142	0.212	
Eagle Green 89	L04G8915MS		15	5.31	135	18	80	29.5	131.4	40.6	180.5	50.7	225.5	0.141	0.21	
Eagle Green 89 Textured	4905315		15	5.31	135	13.1	58.1	21.5	95.4	29.5	131.1	36.8	163.8	0.141	0.21	
Eagle Red 90	4999315		15	5.91	150	59.1	262.9	85.2	378.8	107.2	476.8	125.4	557.9	0.144	0.214	
Eagle Beige 95	L04BE9515M		15	5.91	150	47.8	212.5	67.7	301.2	84.6	376.2	98.9	440	0.146	0.217	
Eagle White 40D	L04BY4015		15	7.09	180	46.8	208.1	71.9	319.9	94.3	419.6	113.6	505.4	0.139	0.207	
Eagle Blue 55D	L04BY5515		15	7.68	195	88.3	392.9	135.9	604.6	176.7	785.8	209.3	931	0.142	0.212	
Eagle Blue 80 MD	4941107	5/8		4.38	111	8.4	37.5	13.1	58.2	17.4	77.6	21.7	96.4	0.149	0.222	
Eagle Orange 85	1032020	5/8		5	127	12.1	53.9	18.7	83.1	24.9	110.8	30.7	136.5	0.16	0.238	
Eagle Clear 85	4908030	5/8		5	127	12.1	53.9	18.7	83.1	24.9	110.8	30.7	136.5	0.16	0.238	
Eagle Clear 95	4907030	5/8		6.25	159	22.7	100.9	33.7	149.8	43.2	192.3	51.4	228.7	0.164	0.243	
Eagle Clear 85 QC	4934030	.625 × .273*		5	127	5	22.1	7.7	34.2	10.3	45.9	12.7	56.6	0.129	0.192	
Eagle Yellow 85 QC	4934020	.625 × .273*		5	127	5	22.1	7.7	34.2	10.3	45.9	12.7	56.6	0.129	0.192	
Eagle Clear 85 QC	L04QC8516M	16 × 6.8*	5.04	5.1	128	5.1	22.7	7.9	35.2	10.6	47.2	13.1	58.2	0.133	0.198	
Eagle Red 85 QC	L04QR8516M	16 × 6.8*	5.04	5.1	128	5.1	22.7	7.9	35.2	10.6	47.2	13.1	58.2	0.133	0.198	
QC Connectors	4935030	15/pack														
REINFORCED		Part Number	Dimensions Ø		Minimum Pulley Ø		Working Load @ Percent Tension								Weight	
Material and Color	(in)		(mm)	(in)	(mm)	1% (N)		2% (N)		3% (N)		4% (N)		lbs/ft	kg/m	
Eagle Orange 85	L04OG8515MR		15	5.91	150	4.5	19.9	15.5	68.9	30.2	134.3	43.3	192.8	0.142	0.212	
Eagle Green 89	L04G8915MRS		15	5.91	150	15	66.5	44.9	199.9	92	409.3	141.9	631.2	0.141	0.21	
Eagle Green 89 Textured	4940054		15	5.91	150	20.6	91.5	61.8	274.8	126.5	562.8	195.1	867.9	0.141	0.21	
Eagle Beige 95	L04BE9515R		15	7.09	180	13.5	60.1	24.7	109.9	36.5	162.4	47.8	212.6	0.146	0.217	
Eagle Hyfen 85	5218030	5/8		6.88	175	16.7	74.3	36.6	162.8	58	258	75.8	337.2	0.16	0.238	

Trackstar® Round Belt Guides

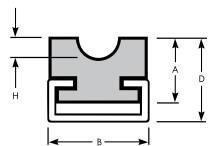

	Part Numbers			Channel Type	A	B	D	H
	Galvanized Channel	Stainless Steel Channel	Aluminum Channel					
Belt Guide w/ Mounting Channel	GB1005-5G	GB1005-5S		C5	0.71	1.1	0.94	0.35

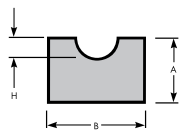

	Part Number	A	B	H
Belt Guide	NC1005	1	1.25	0.35

* QC dimensions are shown O.D × I.D. (O.D. is the outer diameter of the belt. I.D. is the inner diameter of the belt.) Dimensions are for reference only.

18mm, 20mm, 3/4" Round Cross Sections

Round Link Belting

LINK BELTING	Part Number		Cross Section	Minimum Pulley Ø		Max Product Weight w/Idlers		Max Product Weight w/UHMW	
	25'	10m		(in)	(mm)	(lbs)	(kg)	(lbs)	(kg)
Tango™ Belting	0470525	0470533	3/4"	8.5	216	360	163	120	54

Round Belting

NON-REINFORCED		Part Number	Dimensions Ø		Minimum Pulley Ø		Working Load @ Percent Tension								Weight	
Material and Color			(in)	(mm)	(in)	(mm)	4% (N)		6% (N)		8% (N)		10% (N)		lbs/ft	kg/m
Eagle® Green 89	L04G8918MS		18	6.38	162	25.9	115.2	42.5	189.2	58.4	259.9	73	324.6	0.203	0.303	
Eagle Green 89 Textured	4940091		18	6.38	162	18.8	83.7	30.9	137.5	42.4	188.8	53	235.9	0.203	0.303	
Eagle White 40D	L04BY4018		18	8.5	216	67.4	299.7	103.6	460.7	135.8	604.2	163.6	727.8	0.2	0.298	
Eagle Blue 55D	L04BY5518		18	9.21	234	127.2	565.8	195.7	870.6	254.4	1131.6	301.4	1340.7	0.205	0.305	
Eagle Orange 85	1032024		3/4	6	152	17.5	77.7	26.9	119.6	35.9	159.6	44.2	196.6	0.23	0.342	
Eagle Clear 85	4908033		3/4	6	152	17.5	77.7	26.9	119.6	35.9	159.6	44.2	196.6	0.23	0.342	
Eagle Clear 95	4907033		3/4	7.5	191	32.7	145.3	48.5	215.7	62.3	277	74	329.4	0.236	0.351	
REINFORCED		Part Number	Dimensions Ø		Minimum Pulley Ø		Working Load @ Percent Tension								Weight	
Material and Color			(in)	(mm)	(in)	(mm)	1% (N)		2% (N)		3% (N)		4% (N)		lbs/ft	kg/m
Eagle Green 89 Textured	4940055		18	7.09	180	29.6	131.7	89	395.7	182.2	810.5	280.9	1249.7	0.203	0.303	
Eagle Orange 85	4940064		3/4	7.5	191	7.2	32.1	25	111.1	48.7	216.6	69.9	311	0.23	0.342	
Eagle Hyfen 85	5218033		3/4	8.25	210	16.7	74.3	36.6	162.8	58	258	75.8	337.2	0.23	0.342	

Trackstar® Round Belt Guides

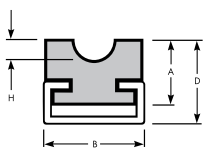

	Part Numbers			Channel Type	A	B	D	H
	Galvanized Channel	Stainless Steel Channel	Aluminum Channel					
Belt Guide w/ Mounting Channel	GB1007-5G	GB1007-5S		C5	1.02	1.1	1.26	0.41

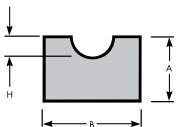

	Part Number	A	B	H
Belt Guide	NC1007	1	1.5	0.41

Round Belting – 20mm

NON-REINFORCED		Part Number	Dimensions Ø		Minimum Pulley Ø		Working Load @ Percent Tension								Weight	
Material and Color			(in)	(mm)	(in)	(mm)	4% (N)		6% (N)		8% (N)		10% (N)		lbs/ft	kg/m
Eagle Green 89	L04G8920MS		20	7.09	180	32	142.3	52.5	233.5	72.1	320.8	90.1	400.8	0.251	0.374	
Eagle Green 89 Textured	4940092		20	7.09	180	23.2	103.4	38.1	169.7	52.4	233.1	65.5	291.2	0.251	0.374	
Eagle White 40D	L04BY4020		20	9.45	240	83.2	370	127.9	568.7	167.7	745.9	202	898.6	0.247	0.368	